



R. Madre Maria Teodora

26.00m

Portão existente

Fundos

15.20m

7.20m

Muro existente

Cercado lateral direito

29.50m

Cercado lateral esquerdo

74.90m

Cercado frontal

41.65m

0.95m

Filinto-Müller

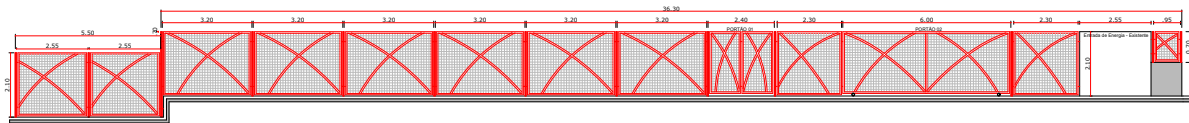

CERCADO FRONTAL
ESC.....1/200

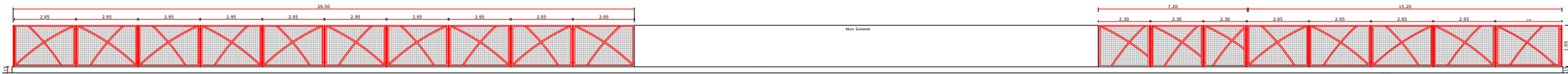

CERCADO LATERAL DIREITO
ESC.....1/200

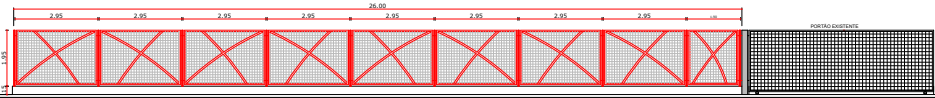

CERCADO DOS FUNDOS
ESC.....1/200

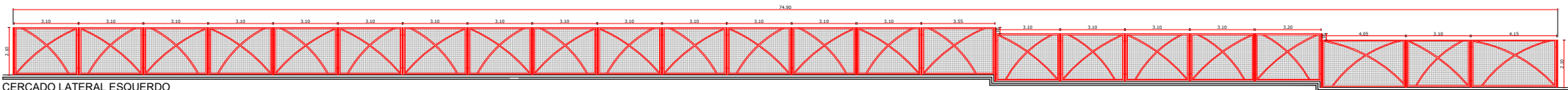

CERCADO LATERAL ESQUERDO
ESC.....1/200

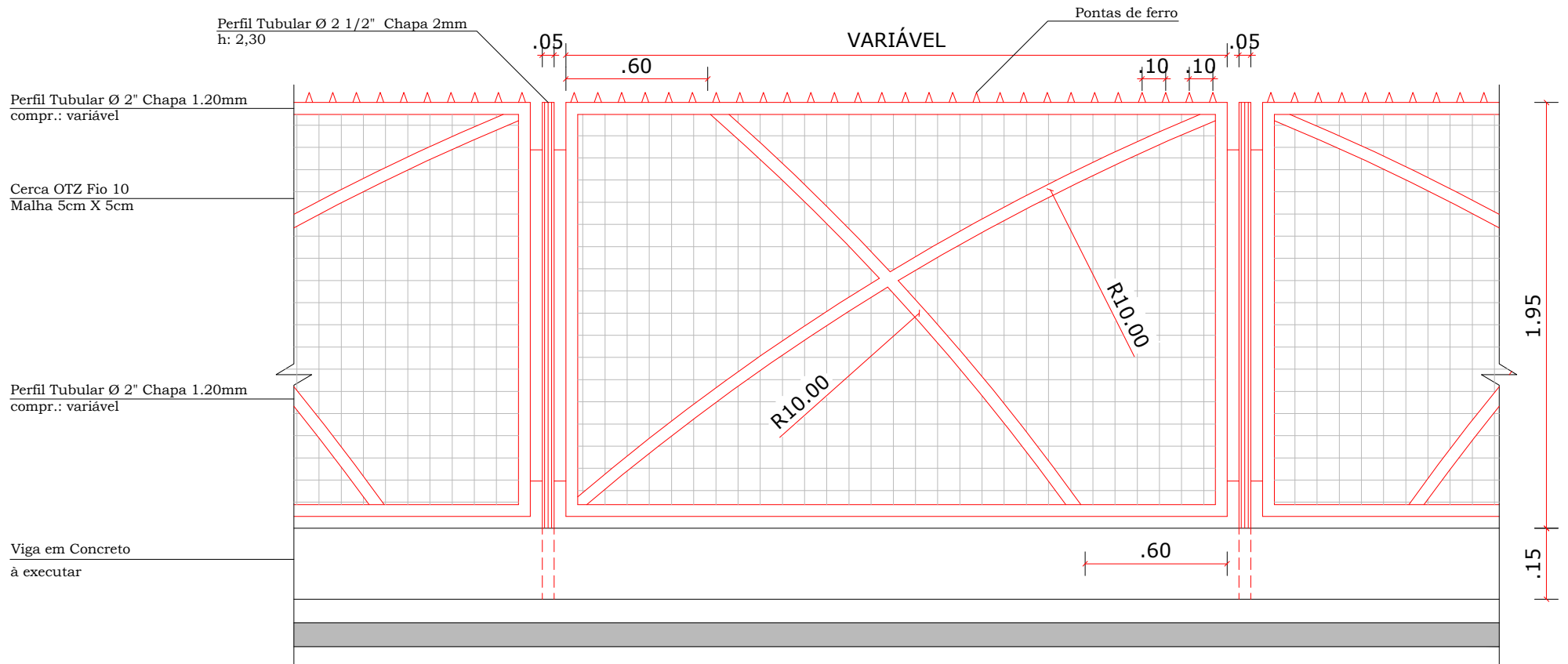

DETALHE CERCADO COM VIGA
ESC.....1/25

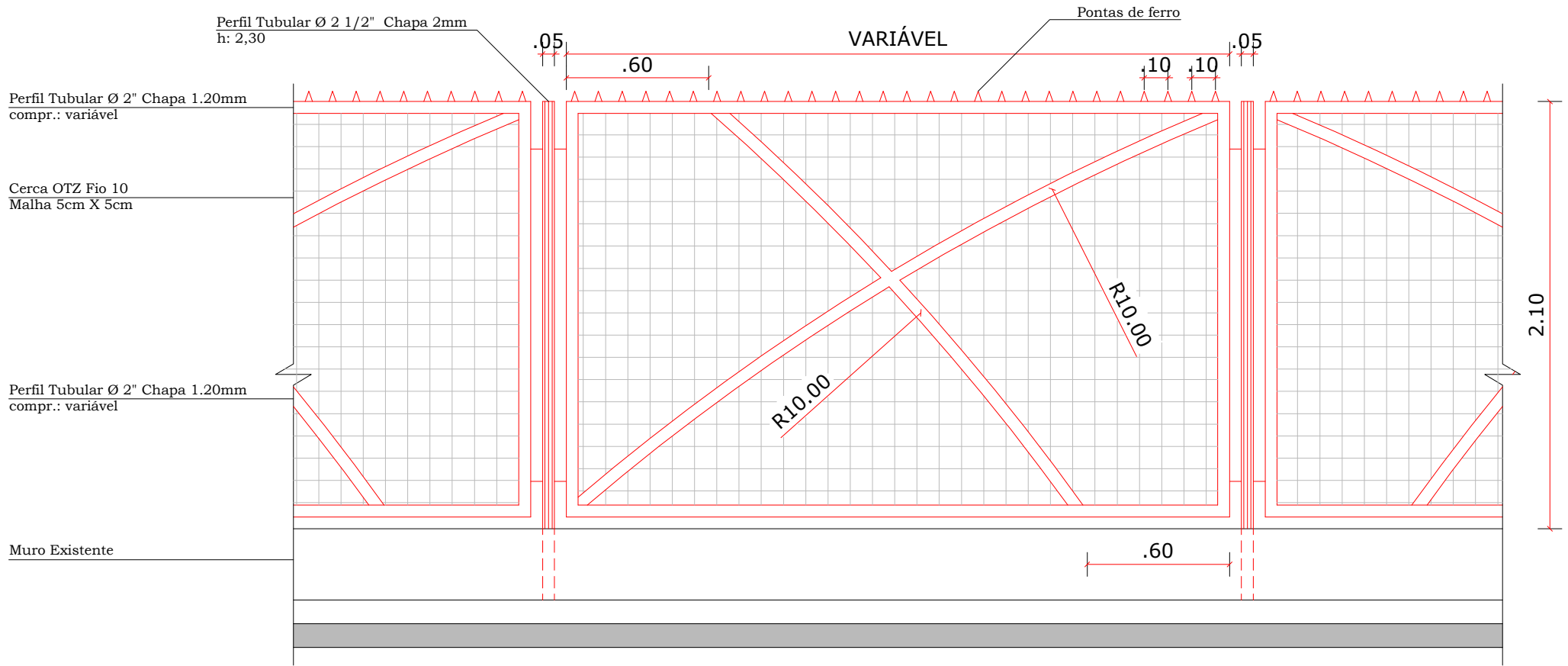

DETALHE CERCADO SOBRE MURO
 ESC.....1/25