

Detalhe Fechamento Portões  
ESC.....1/10

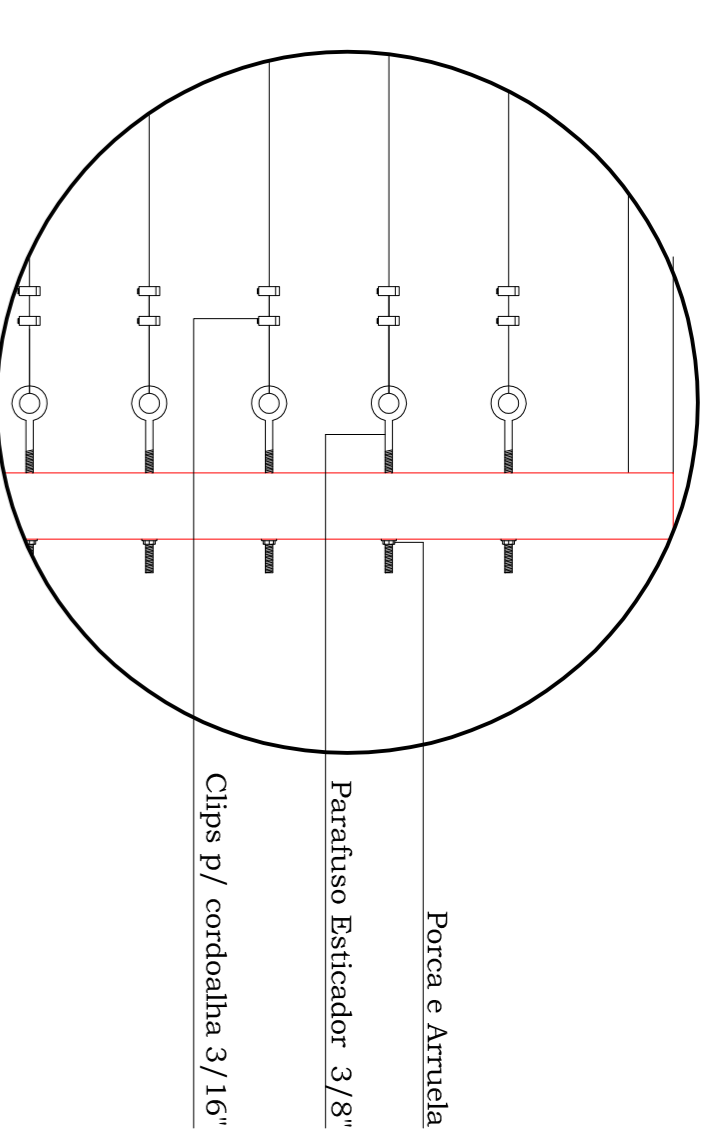

Detalhe Esticadores  
ESC.....1/10

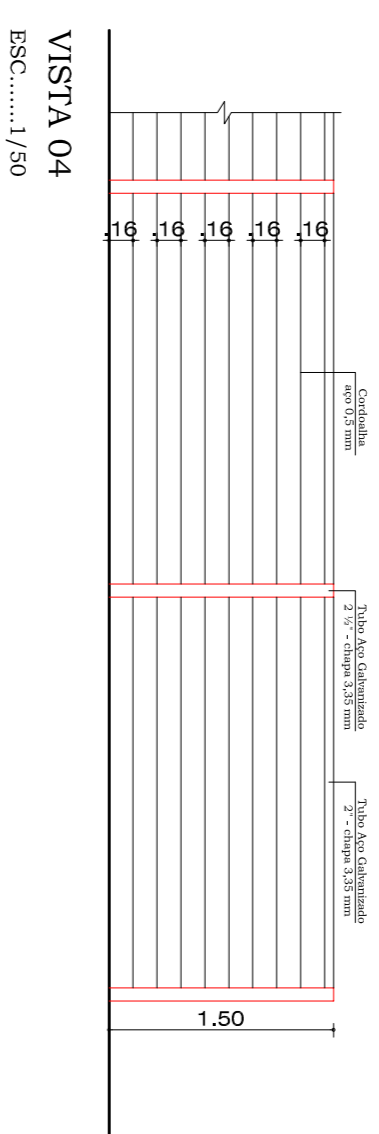
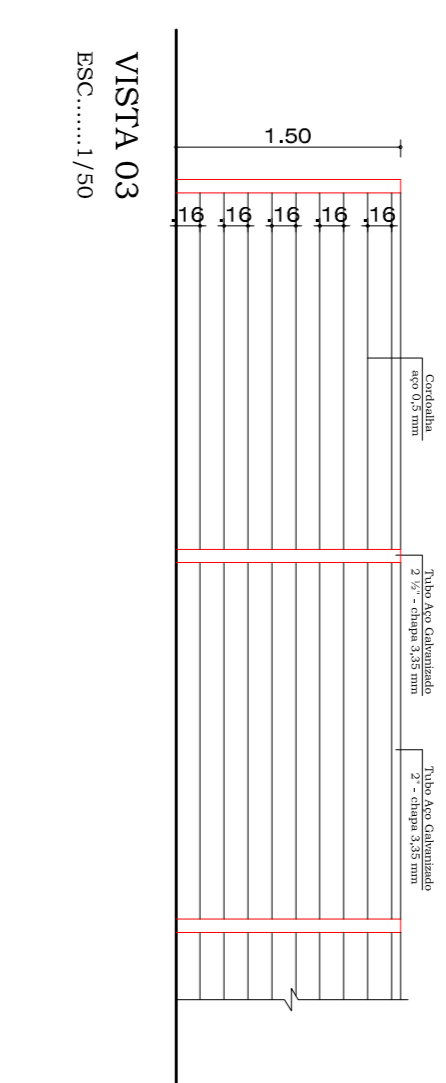

Portões 01-04-06

Portão 05

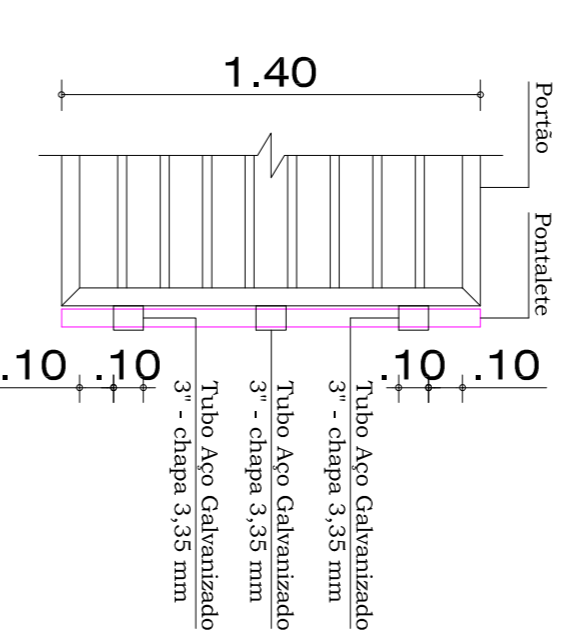
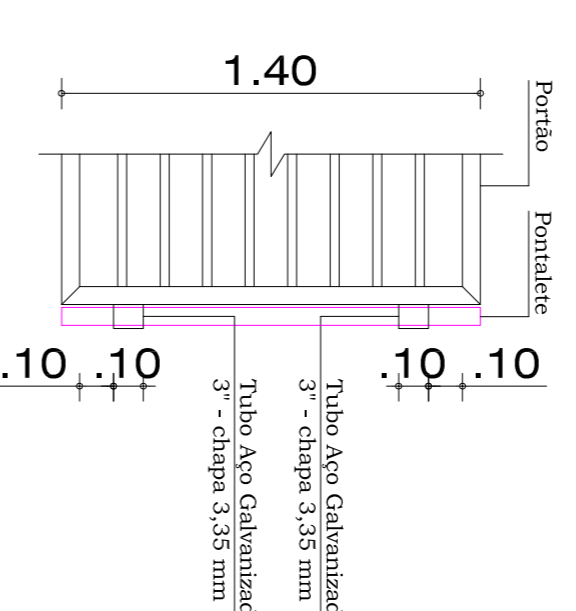

Detalhe Fixação dos Portões  
ESC.....1/50

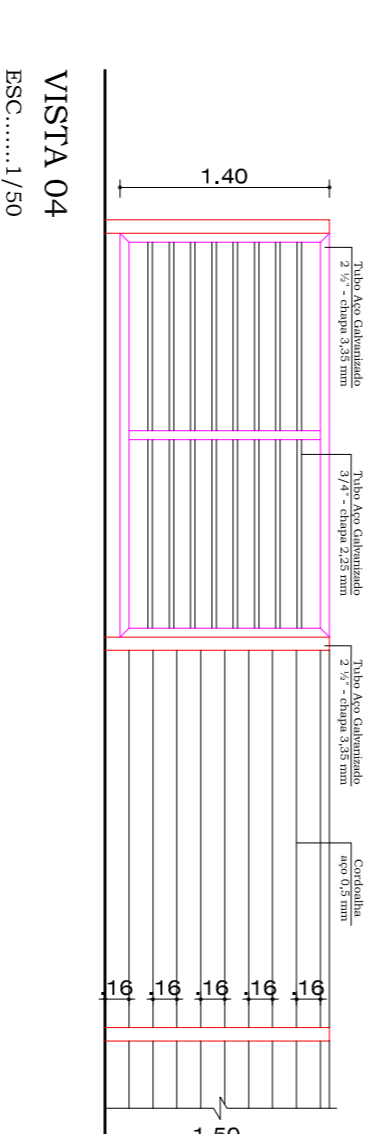
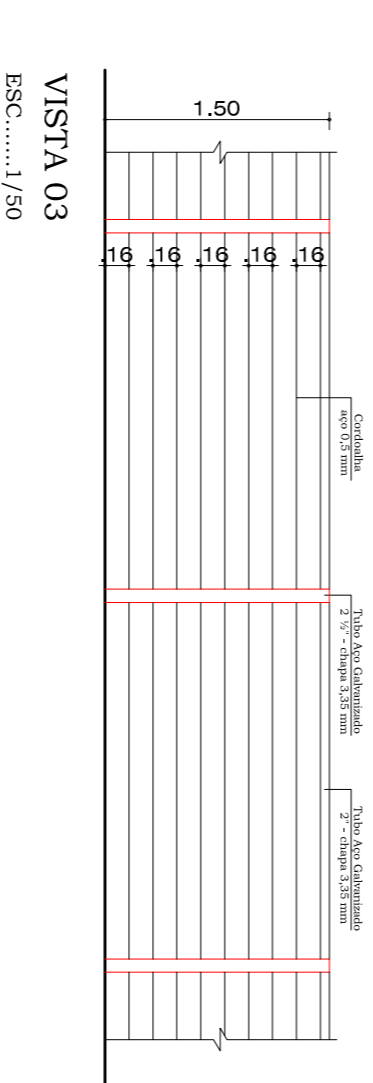
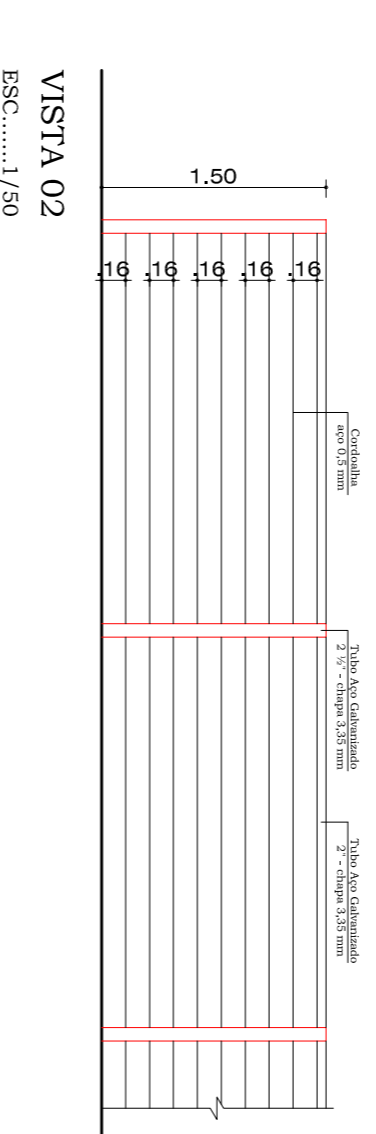
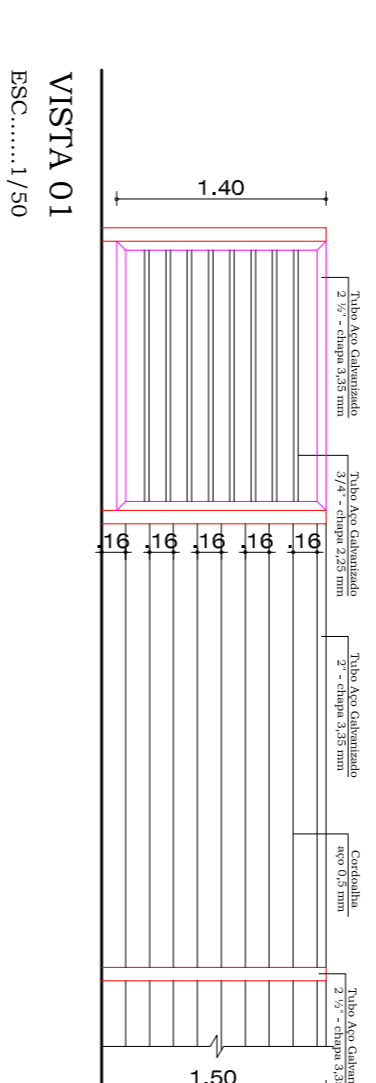
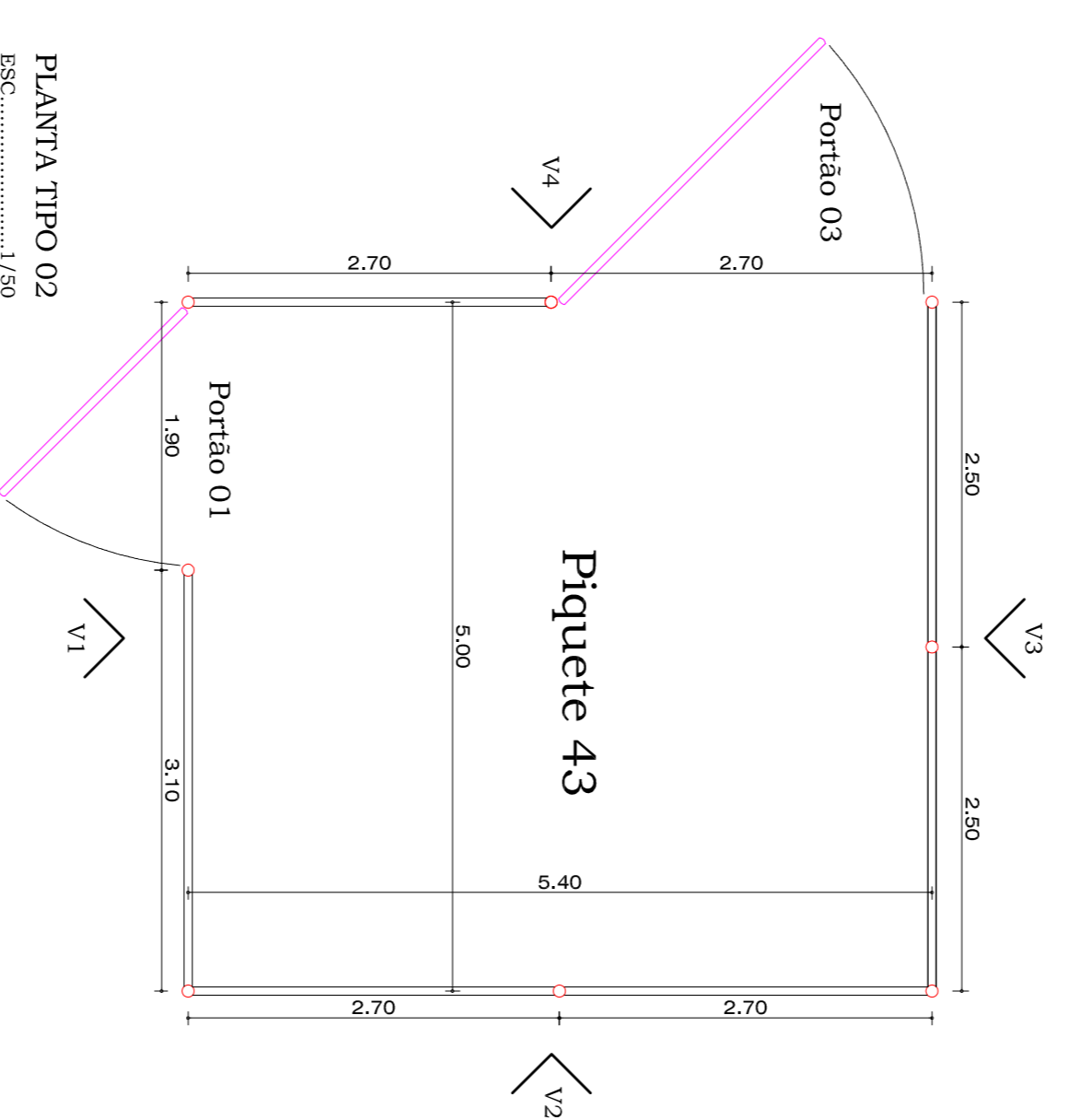

PLANTA TIPO 02  
ESC.....1/50



Parafuso Esticador  
3/8" - 200mm



Clips p/ cordoalha  
3/16"

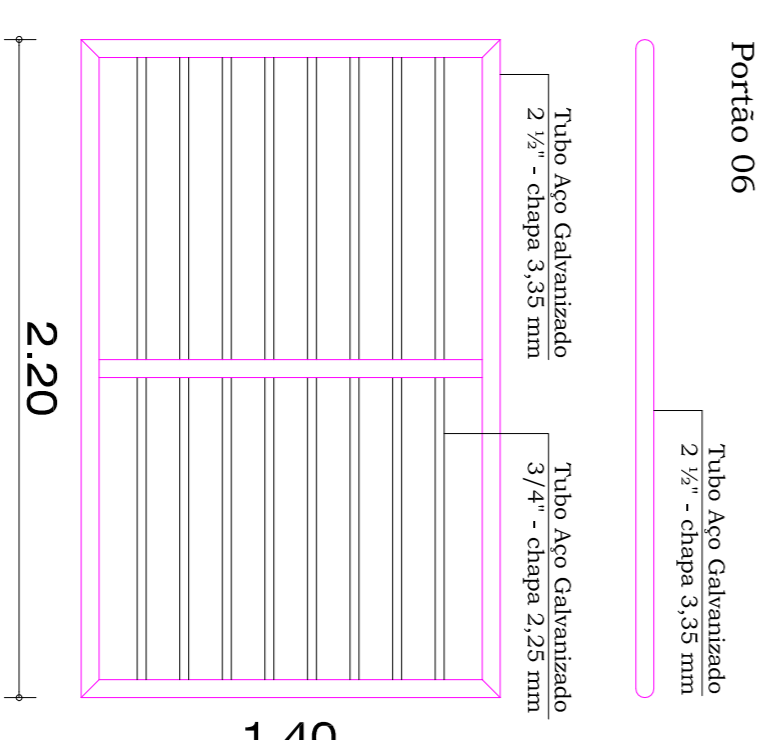
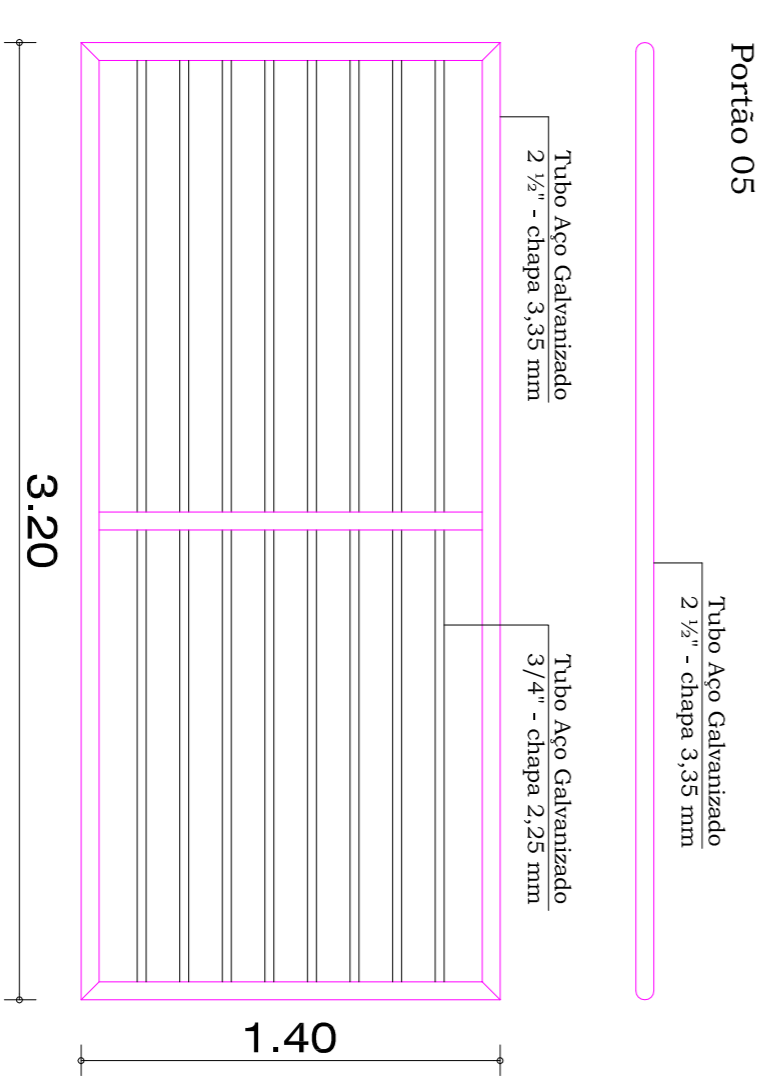
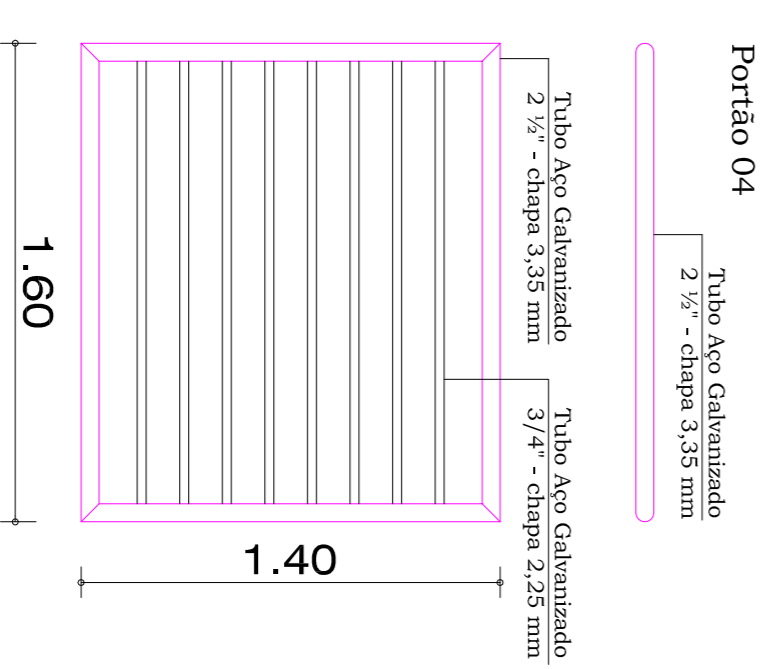
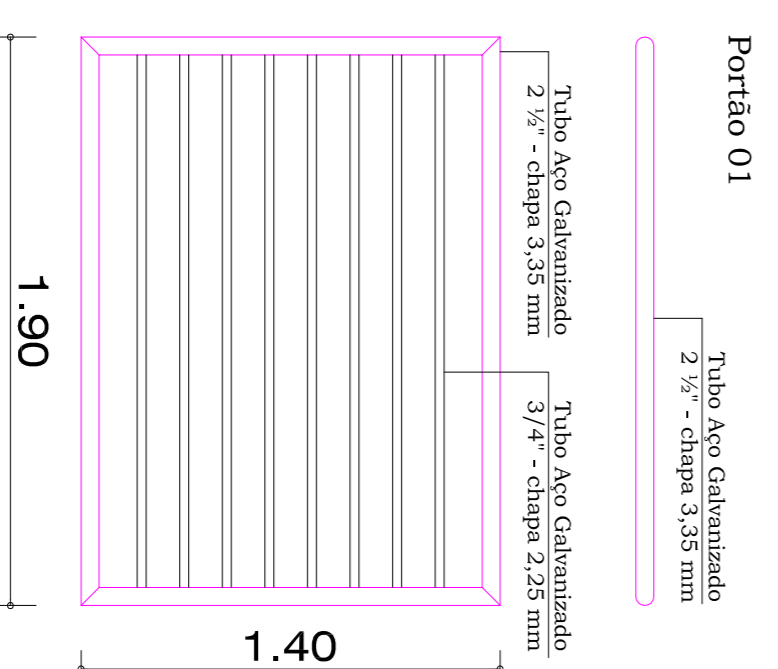

Detalhe dos Portões  
ESC.....1/50

## ARQUITETÔNICO

ESTADO DE SANTA CATARINA

PREFEITURA MUNICIPAL DE PONTE SERRADA

		Engenharia civil CREA - 11.810 - 3/SC ALTAIR FAZOLE	
Rua Rodozindo Pavan, 170 - Ponte Serrada - SC (049 - 34350014)		Assinatura Eduardo Coppini	
Escalas Julho / 2016 INDICADAS		Área: Mangueiras: 3.572,00 m <sup>2</sup>	
Tipo Construção de Mangueiras		Projeto 02/103	
Desenho Maurício Renani Mendes		Proponente Prefeitura Municipal de Ponte Serrada	
Local PONTE SERRADA - SC			